

# VIDEO ENTRY SYSTEM

Indoor Monitor

Outdoor Station

Power Supply

CP-VK70S-VP

- 
- Operation
  - Installation
  - Manual

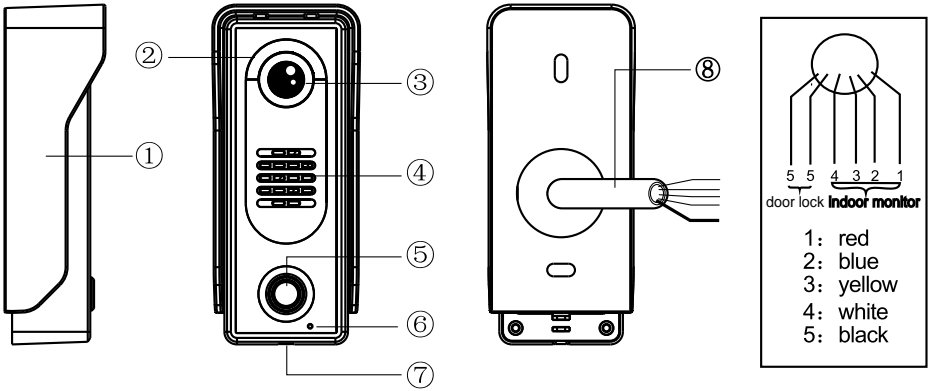

**Dimension: 58x135x39mm**

NO.	NAME	DESCRIPTION
①	Water cover	Protect the camera from outside water
②	LED assistant	Provide lighting during night time for better visibility
③	CCD camera	Capture the image to sent to the monitor
④	Speaker	Sound from the monitor is delivered
⑤	Calling button	Call the indoor phone to communicate
⑥	Microphone	Delivers and sound voice when communication with the indoor phone
⑦	Screw hole	Install the screws
⑧	Connection wiring	Connection with the monitor

# Specification

Power	DC 14.5V
Working electric current	200mA
Camera lens	1/3 CCD 72 degree ken
Illumination	0.05 LUX
Communication duration	120s
Communication method	Duplex communication type
Working temperature	-20 ~ +55°C
IP rating	55

# Installation Process

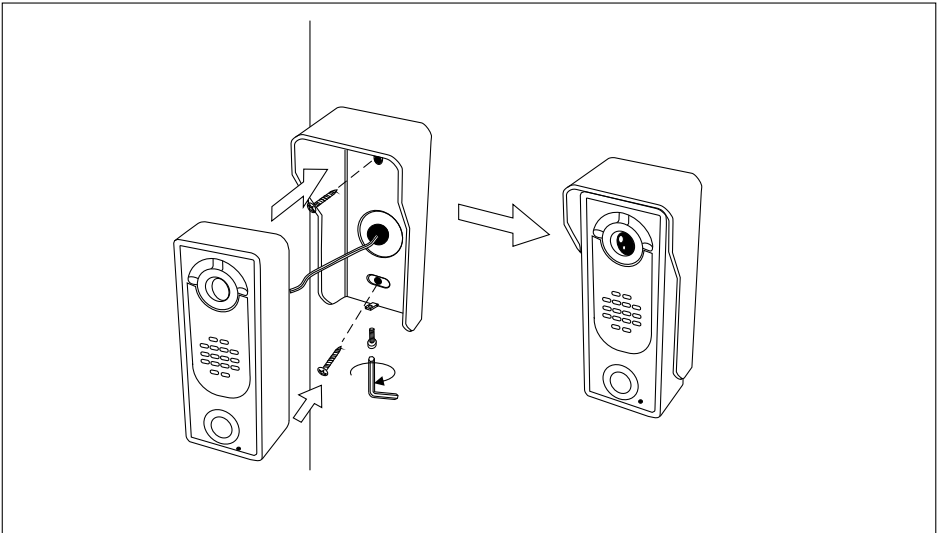

# INDOOR MONITOR

CP-VK70-VP

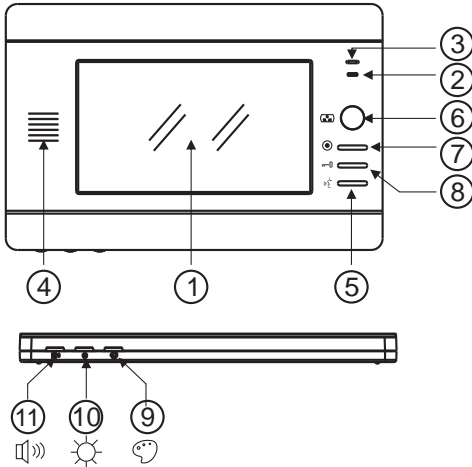

Dimension: 245x160x18mm

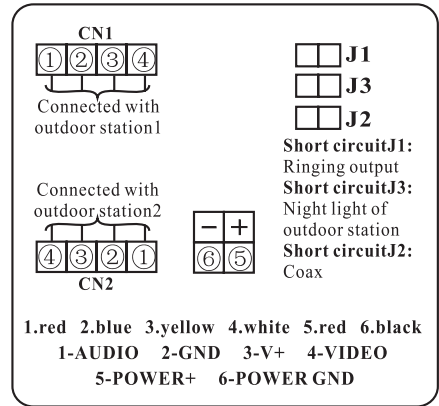

NO.	Icon	Description	NO.	Icon	Description
①		TFT display	⑦	⦿	Calling
②		Power indicator	⑧	🔑	Door lock releasing
③		Microphone	⑨	💬	Chroma/contrast
④		Speaker	⑩	☀️	Brightness
⑤	🗣️	Talking	⑪	🔊	Talking volume
⑥	📺	Monitor			

## CAUTION:

- When connect more than one indoor monitor please short circuit J2 of the far the most monitor and open J2 of the other monitors.
- When connect more than one indoor monitor please short circuit J1 and J3 of the closest monitor and open J1 and J3 of other monitors.

# Specification

Working condition	Temperature: $-10 \sim +55^{\circ}\text{C}$
	$\text{RH} \leq 95\%$
Voltage	DC14.5V
Standby current	$\leq 50\text{mA}$
Working current	$\leq 600\text{mA}$
Mode	Dual transmission
Talking time	2 minutes
Transmission distance $\leq 28\text{m}$ , wire $\geq 0.2\text{mm}^2$	
Transmission distance $\leq 50\text{m}$ , wire $\geq 0.3\text{mm}^2$	
Transmission distance $\leq 70\text{m}$ , wire $\geq 0.5\text{mm}^2$	

# Configuration Diagram

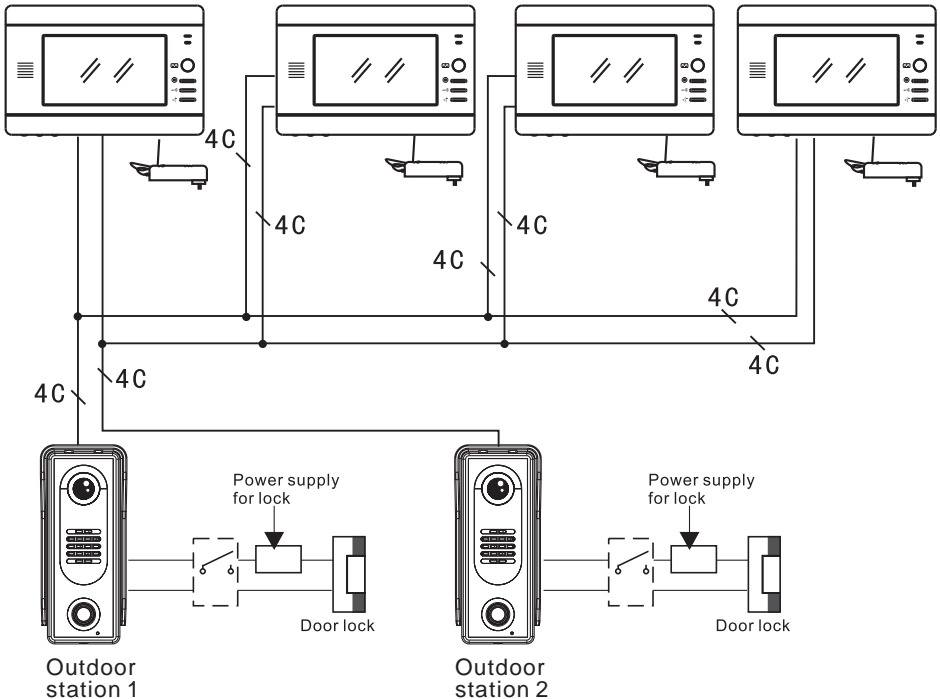

# Wiring Connections

- |         |         |           |          |
|---------|---------|-----------|----------|
| 1. Red  | 2. Blue | 3. Yellow | 4. White |
| 1-Audio | 2-GND   | 3-V+      | 4-Video  |

## Indoor Monitor

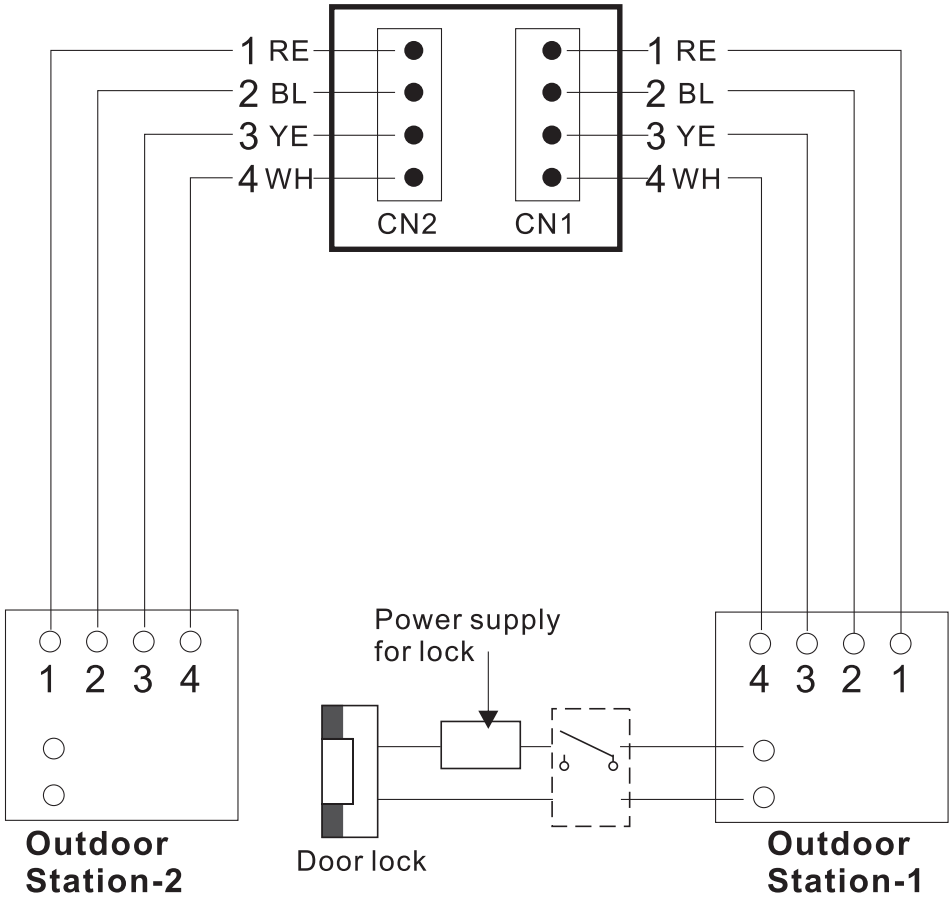

# Operation

## ► Visitor call

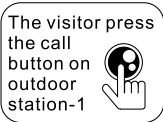

a chime sounds

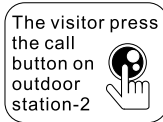

a chime sounds

\*A view of the front door can be seen anytime the entrance button is pressed and a dialogue can be made with anyone at the front door.

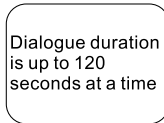
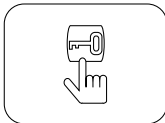
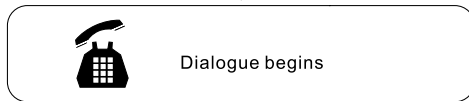
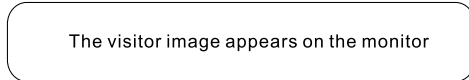

To check

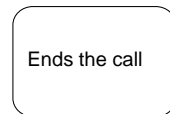
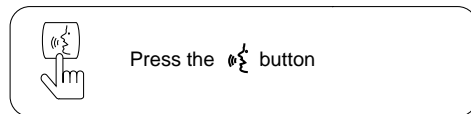

## ▶ MONITOR

---

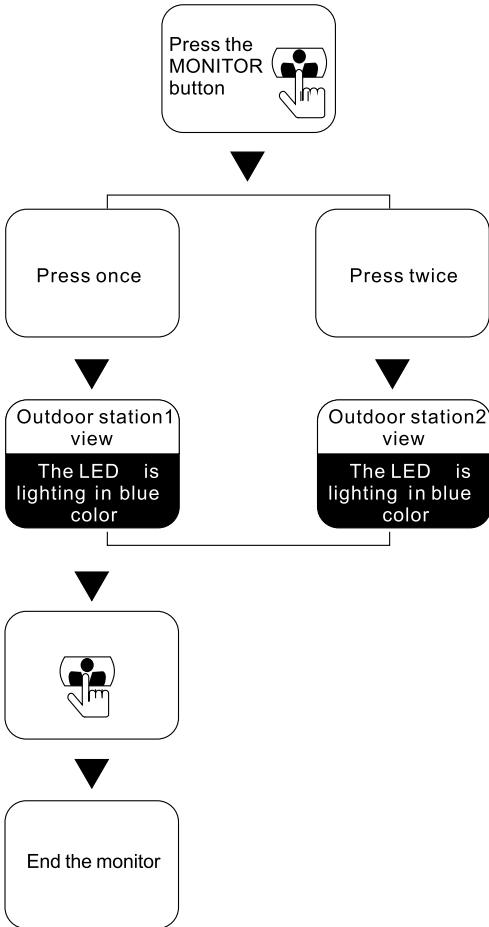

\* This function is to see the image of entrance.

## ▶ Indoor monitor call transferring

---

### ■ Call from indoor monitor



Other indoor monitors ring.

▶ Press to end call.

Press the button, any indoor monitor can talk with outdoor station.



## Installation instruction



### Notice

1. The installation place should be far away from TV, video record player, PC etc. Electronic units with high intensity EMC.
2. Do not drop, knock or shake the unit.
3. Shut down the power for the unit while installing.
4. The wiring cable installation should keep 30 cm away from the high voltage cable as minimum distance, reducing the disturb from high voltage.
5. Before take power for the unit, recheck the wiring diagram and make sure done right connection.
6. Meet with unnormal phenomenon when the unit is working, cut down the power first and then do eliminate of defects.
7. Eliminate of defects after shut down the power, do check step by step from one unit to another unit, or do cross-test that means take substitute(a new one). After done above processings, if still has unknown defect, contact with our company for after service. Nonexpertive handing may damage the unit.

### Installation processes

1. Position the location when the unit is to be mounted. Use the bracket to mark the accurately location point.
2. Use the screw anchors to fill the drilling hole, and screwing fasten the bracket to the wall.
3. According to the wiring diagram and do right connection.
4. Mounted the unit to the bracket.

# Installing diagram

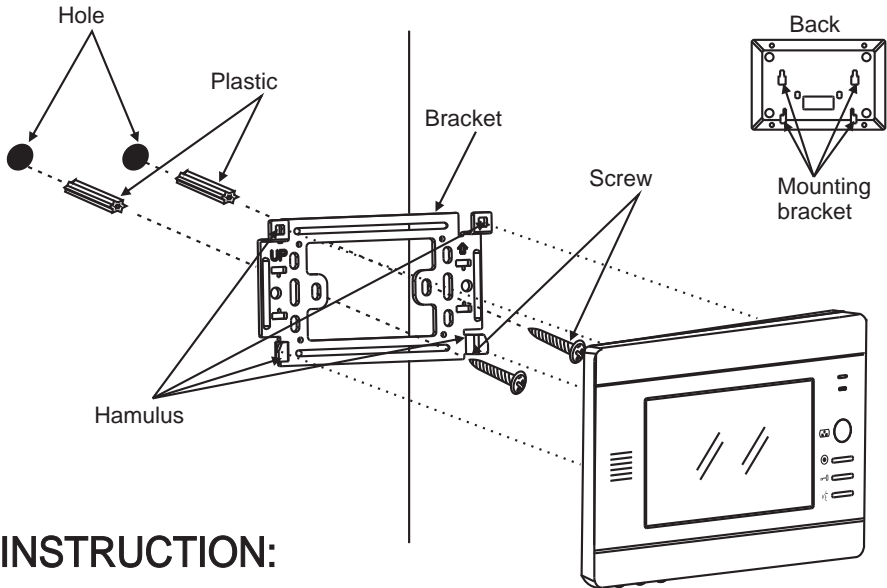

## INSTRUCTION:

1. Cables of LCC system:
  - ① Non-wired cable.
  - ② Diameter  $\geq 0.5\text{mm}^2$ , from outdoor station to the farthest monitor distance  $\leq 70\text{m}$ .
2. Each monitor should be parallel connected. One monitor can be extended 3 monitors as maximum extension. One monitor can be connected 2 outdoor stations as maximum.
3. Handset monitor only has 2 functional buttons. Hand-free monitor only has 2 functional buttons, not available for transferring-call function.
4. Built-in power supply video door phone can working with input AC voltage directly. Non-built-in power supply needs plus a power supply the specification is DC 14.5V 1.3A.

*Delton*

1141 Budapest, Fogarasi út 77.  
Tel.: \*220-7940, 220-7814, 220-7959,  
220-8881, 364-3428 Fax: 220-7940  
Mobil: 30 531-5454, 30 939-9989

1095 Budapest, Mester utca 34.  
Tel.: \*218-5542, 215-9771, 215-7550,  
216-7017, 216-7018 Fax: 218-5542  
Mobil: 30 940-1970, 20 949-2688

[www.cplusplus.hu](http://www.cplusplus.hu)

E-mail: [info@delton.hu](mailto:info@delton.hu) Web: [www.delton.hu](http://www.delton.hu)